

eLive LED Modular Track Systems

The Elive LED Modular Track Lighting systems have been designed to allow you to enhance your lighting needs as you grow with the hobby. If you desire to increase your light output to keep live plants or low light corals then upgrading your light to meet your needs is simple. Just purchase more LED PODs to customize the light output. Easy Change™ LED PODs allow you to quickly and easily add, remove, and reposition LEDs to achieve your desired light intensity, color, and pattern.

Increase brightness by adding additional LED PODs. Customize your light color by combining different types of LED PODs. Highlight areas in your aquarium by moving LED PODs on the track system to position the light accordingly. Visit www.elivepet.com for more detailed information about this product.

Ask your local retailer for Elive Easy Change™ LED PODs

Cool White

10,000K Cool White LEDs – Bright white daylight

Lunar Blue

445nm Blue LEDs – Blue moonlight and night time accent lighting

Color Enhancing

4,500K Warm White & 630nm Red LEDs – Ideal for freshwater planted aquariums, red/orange color enhancing, or creating a warmer daylight effect

Limited 12-Month Warranty

What the Warranty Covers

Elive (Company) warrants this Elive product (see exclusions below) to the original purchaser against defective material and workmanship that occurs during normal in-home use for 12 months from the original purchase date. Company will, at Company's option, either repair or replace same without charge (but no cash refunds will be made). This warranty is limited to replacement or repair of product only and does not cover loss of aquarium life, personal injury, property loss, or damage arising from the use of the product.

Exclusions:

1. Damage resulting from accident, misuse, abuse, lack of reasonable care, subjecting the product to any but the specified electrical service, other than normal or ordinary use of the product, subjecting the product to abnormal working conditions or any other failure not resulting from defects in materials or workmanship.
2. Damage resulting from modification, tampering with, or attempted repair by anyone other than the Company.
3. Transfer of product to someone other than the original consumer purchaser.

THIS CONSTITUTES ELIVE'S ENTIRE WARRANTY AND ELIVE MAKES NO OTHER WARRANTIES, WHETHER EXPRESSED OR IMPLIED, WITH RESPECT TO THE PRODUCT. ELIVE SPECIFICALLY DISCLAIMS ANY AND ALL IMPLIED WARRANTIES, INCLUDING, WITHOUT LIMITATION, WARRANTIES OF MERCHANTABILITY AND FITNESS FOR A PARTICULAR PURPOSE. IF ELIVE CANNOT LAWFULLY DISCLAIM IMPLIED WARRANTIES UNDER THIS LIMITED WARRANTY, ALL SUCH WARRANTIES, INCLUDING WARRANTIES OF MERCHANTABILITY AND FITNESS FOR A PARTICULAR PURPOSE ARE LIMITED IN DURATION TO THE DURATION OF THIS WARRANTY.

Company shall not have any obligations under this warranty unless the owner notifies the Company in writing of any alleged defect(s) within 30 days of discovery of the defect(s).

What you must do to enforce the warranty:

Contact the Company by telephone at
1-855-ELIVE18 / 1-855-354-8318

Or contact the Company by writing to
Elive LLC
2725 South Moorland Road Suite# 102
New Berlin, WI 53151
Attention: Warranty

Or contact the Company by email to
elivesupport@livepet.com
Via website www.elivepet.com

You must pay any postage, shipping charges, insurance costs and other expenses to return the product along with the original cash register receipt to Elive LLC. However, if the necessary repairs are covered by the warranty, the Company will pay the return shipping charges to any destination within the United States or Canada. Company shall be allowed a reasonable period of time to investigate any warranty claim and to perform any testing Company deems necessary to determine the cause of the defect. This warranty shall be interpreted under the laws of the state of Wisconsin.

Limitation of implied warranties and exclusion of certain damages:

The Company disclaims liability for incidental and consequential damages for breach of any express or implied warranty, including any implied warranty of merchantability, with respect to this product. This writing constitutes the entire agreement of the parties with respect to the subject matter hereof: no waiver or amendment shall be valid unless in writing signed by the Company. Some states do not allow the exclusion or limitation of consequential damages, so the above limitation or exclusion may not apply to you.

MADE IN CHINA

Elive LLC
2725 South Moorland Road, Suite 102
New Berlin, WI 53151
1.855.ELIVE18 / 1.855.354.8318
livepet.com

elive™
extraordinary pets

INSTRUCTION MANUAL

Item #s 01300, 01301, 01302, 01303, 01304



Elive LED Track Light Transformers are listed by Underwriters Laboratories to ensure that they meet the stringent U.S. and Canadian safety requirements.

Transformer

THIS PRODUCT IS INTENDED FOR USE OVER GLASS COVERED AQUARIUMS ONLY.

Check to make sure none of the fixture components are damaged before installation. If damaged parts are discovered, call 1-855-ELIVE18 or email elivesupport@elivepet.com for customer support. Do not return the product directly to the retail store.

IMPORTANT SAFETY INSTRUCTIONS

WARNING: To guard against injury, basic safety precautions should be observed including the following:

READ AND FOLLOW ALL SAFETY INSTRUCTIONS

DANGER: To avoid possible electric shock, special care should be taken since water is employed in the use of aquarium equipment. For each of the following situations, do not attempt to repair yourself; return the appliance to an authorized service facility for service or discard the appliance.

1. A. If the appliance shows any sign of abnormal water leakage, immediately unplug it from the power source.
 - B. Carefully examine the appliance after installation. It should not be plugged in if there is water on the parts not intended to be wet.
 - C. Do not operate any appliance if it has a damaged cord or plug, if it is malfunctioning or if it is dropped or damaged in any manner.
 - D. To avoid the possibility of the appliance plug or receptacle getting wet, position aquarium stand and tank to one side of the wall mounted receptacle to prevent water from dripping onto the receptacle or plug. A "drip loop," shown in the figure below, should be arranged by the user for each cord connecting an aquarium appliance to the receptacle. The "drip loop" is the part of the cord below the level of the receptacle, or the connector if an extension cord is used, to prevent water travel along the cord and coming in contact with the receptacle. If the plug or the receptacles do get wet, DO NOT unplug the cord. Disconnect the fuse to the circuit breaker that supplies power to the appliance. Then unplug and examine for the presence of water in the receptacle.
2. Close supervision is necessary when any appliance is used by or near children.
 3. To avoid injury, do not contact moving parts or hot parts such as heaters, reflectors, lamp bulbs, etc.
 4. Always unplug an appliance from the outlet when not in use, before putting on or taking off parts, and before cleaning. Never yank the cord to pull plug from the outlet. Grasp the plug and pull to disconnect.
 5. Do not use an appliance for other than intended use. The use of attachments not recommended or sold by the appliance manufacturer may cause an unsafe condition.
6. Do not install or store the appliance where it will be exposed to the weather or to temperatures below freezing (32°F/0°C).
 7. Make sure an appliance mounted on a tank is securely installed before operating it.
 8. Read and observe all the important notices on the appliance.
 9. If an extension cord is necessary, a cord with a proper rating should be used. A cord rated for less amperes or watts than the appliance rating may overheat. Care should be taken to arrange the cord so that it will not be tripped over or pulled from outlet.
 10. ONLY FOR POLARIZED ATTACHMENT PLUG APPLIANCES: If this appliance has a polarized plug (one blade is wider than the other) as a safety feature, this plug will fit in a polarized outlet only one way. If the plug does not fit fully in the outlet, reverse the plug. If it still does not fit, contact a qualified electrician. Never use with an extension cord unless plug can be fully inserted. Do not attempt to defeat this safety feature.

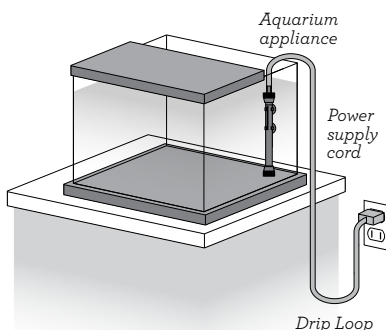

SAVE THESE INSTRUCTIONS

Parts

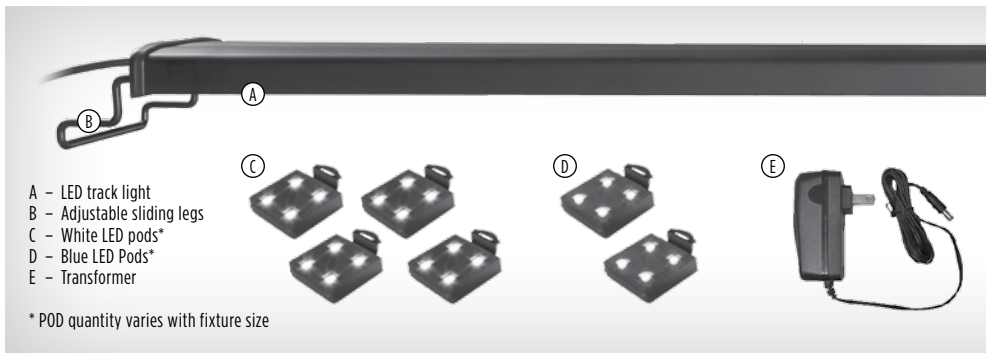

Caution: Before installing or operating the lighting, read and understand all safety

NOTE: The LED PODs may have shifted inside of the fixture during transit. If the LED PODs require repositioning, please refer to the **LED POD Repositioning, Installation and Removal** section of the instructions to complete this before proceeding with installation.

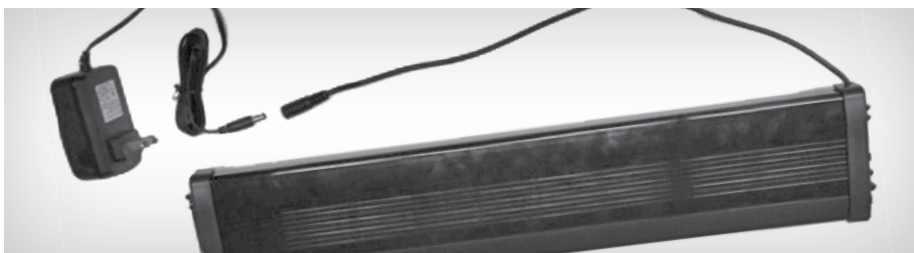

INSTALLATION INSTRUCTIONS

This product is intended for use over glass covered aquariums only.

1 Install the light fixture over the covered aquarium

Make sure it is positioned securely before plugging the fixture in. To install using the adjustable sliding legs, adjust the width of the legs to match the width of the aquarium and securely place the fixture on the frame of the aquarium. The legs should be extended the same amount on both ends of the fixture.

Alternatively, the sliding legs may be removed from the ends of the fixture by slowly pulling them out and the fixture may be set directly onto a glass aquarium cover. The fixture must be positioned securely on the cover. Spacers on the ends of the fixture prevent the face of the fixture from contacting the glass and allow for air circulation on the underside of the fixture.

2 Connect the transformer to the connector on the back of the light fixture

See Figure 1.

3 Plug the transformer into an acceptable outlet

Be sure to incorporate a "drip loop" to prevent water droplets from running down the power cord and into the outlet should any water get onto the cord. The LED Track Light is now ready for use.

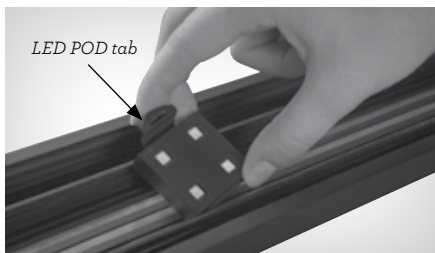
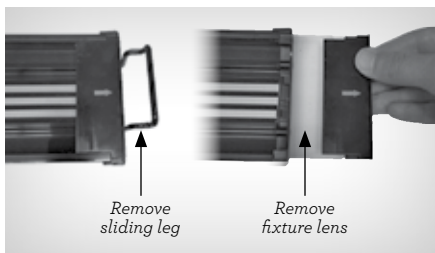
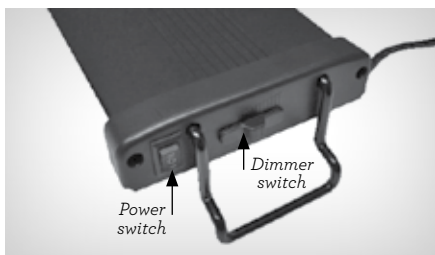

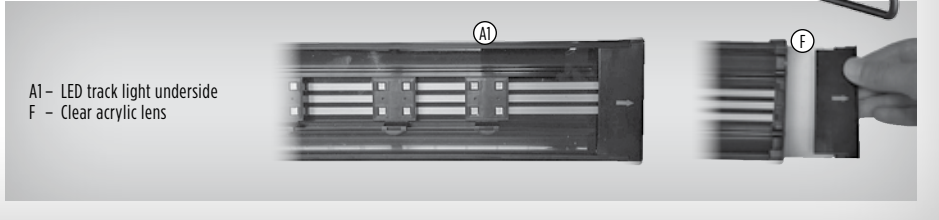

A1 – LED track light underside
F – Clear acrylic lens

Instructions and warnings.

LED POD REPOSITIONING, INSTALLATION AND REMOVAL

- 1 Turn the power switch at the end of the fixture to the off (O) position** (See Figure 2)

Unplug the transformer from the outlet prior to repositioning, installing, or removing an LED POD. Remove the fixture from the aquarium and flip it over onto a clean nonabrasive surface so the underside is accessible.

- 2 Remove the adjustable sliding leg from the end of the fixture opposite of the power switch by slowly pulling it out of the fixture housing**

Remove the fixture lens by slowly pulling on the black lens end with the arrow in the direction of the arrow. (See Figure 3).

WARNING: DO NOT slide the LED PODs along the fixture track to reposition them. This may cause permanent damage to the track of the light fixture.

- 3 To remove an LED POD,** gently press the tab on the POD towards the inside of the light fixture and lift upwards. (See Figure 4).

The LED POD is now removed or may be repositioned by reinstalling it in another location in the fixture.

- 4 To install an LED POD,** first make sure it is oriented properly (the tab must be positioned towards the back of the light fixture).

The LED POD will not install unless oriented correctly. Align the side of the track opposite from the tab into its groove on the front side of the track and gently push the LED POD towards the track until the tab locks into place.

OPERATING INSTRUCTIONS

The Elive LED Track Light has 2 channels of operation, channel 1 for daylight (i.e., Cool White and Color Enhancing LED PODs) and channel 2 for night/accent light (i.e., Lunar Blue LED PODs). The power switch on the end of the fixture (See Figure 2) controls the power to these channels and has 3 positions:

The (II) position supplies power to both channels 1 and 2, turning all of the LED PODs on.

The (I) position supplies power only to channel 2 (night/accent light), turning only the channel 2 LED PODs on.

The (O) position is the off position, turning off all of the LED PODs.

The dimmer switch on the end of the fixture (See Figure 2) allows you to adjust the intensity of the LED PODs on channel 2 (night/ accent light). **When the power switch is in the (II) position** and both LED POD channels are on, adjusting the dimmer will change the color blending and color temperature of the daylight depending on which types of LED PODs are installed. **When the power switch is in the (I) position** and only the night/accent light channel is on, adjusting the dimmer will control the intensity of the night light.

MAINTENANCE INSTRUCTIONS

- 1 Always turn off the light fixture** (by moving the power switch to the O position) and unplug the transformer from outlet prior to performing maintenance.

- 2 Dust, water spray, salt creep, and water scale can create an electrical and fire safety hazard**

if allowed to collect on the fixture. To prevent this hazard, use this product over covered aquariums only and clean the fixture regularly. Periodically wipe the exterior of the fixture down with a clean, dampened towel, and dry thoroughly with a second dry towel. Make sure all surfaces have been dried before use.

LED POD Color Suggestions

Setup Type	Color
General lighting	White
Fish only	White, Blue, Color Enhancing
Freshwater planted	White, Blue, Color Enhancing
Saltwater Low Light Coral	White, Blue
Saltwater Medium Light Coral	White, Blue

Suggested LED POD Quantity

Fixture Size	General Lighting Fish Only	Fish Only Planted	Fish Only	Low or Medium Light Coral
			Planted Low Light Coral	Light Coral
20"	3 to 5	4 to 8	8 to 12	12
24"	5 to 6	5 to 10	10 to 14	13 to 14
30"	6 to 8	7 to 13	13 to 19	18 to 19
36"	7 to 9	8 to 15	15 to 23	21 to 23
48"	10 to 11	10 to 20	20 to 31	29 to 31

Based on aquariums with standard depths and dimensions. More LED PODs or multiple LED light fixtures may be required to illuminate very deep aquariums. Light output will vary depending on the mix of LED POD types and colors used.